

WR112 COAX-WAVEGUIDE ADAPTER

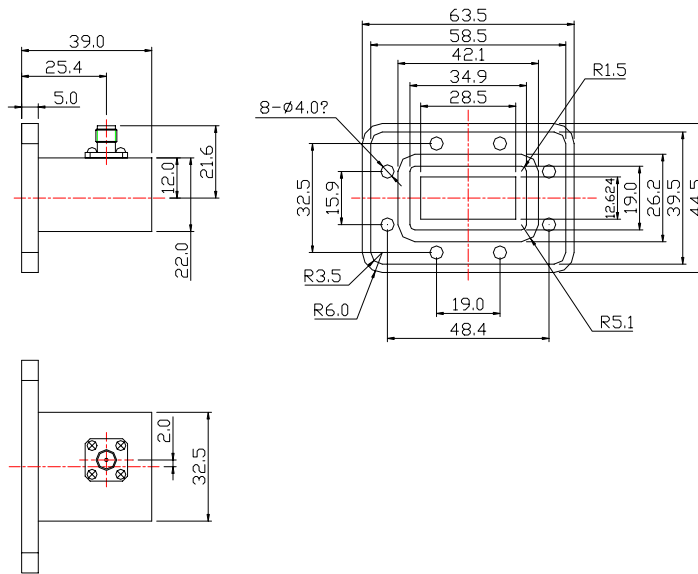

	LENGTH	WIDTH	HEIGHT	TOLERANCE
mm	47.8	47.8	39.0	±0.1
inch	1.88	1.88	1.54	±0.01

SPECIFICATION DETAILS				
F1~F2 GHz	MAX NUMBER	Waveguide Type	VSWR MAX	CONNECTOR
7.05~10	JACWR112SF-PDR84	PDR84	1.25:1	SMA-f

SPECIFICATION MAY BE SUBJECT TO CHANGE