

5		6		
REV.	DESCRIPTION	REVISOR	DATE	APPROVE

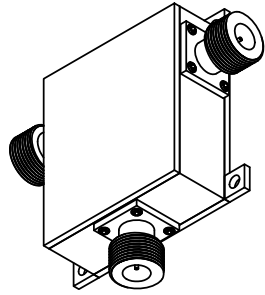
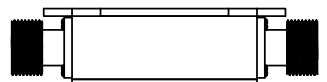
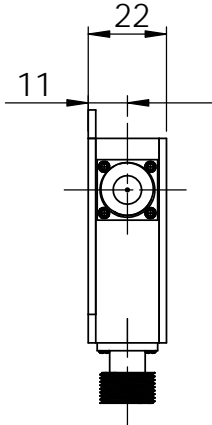
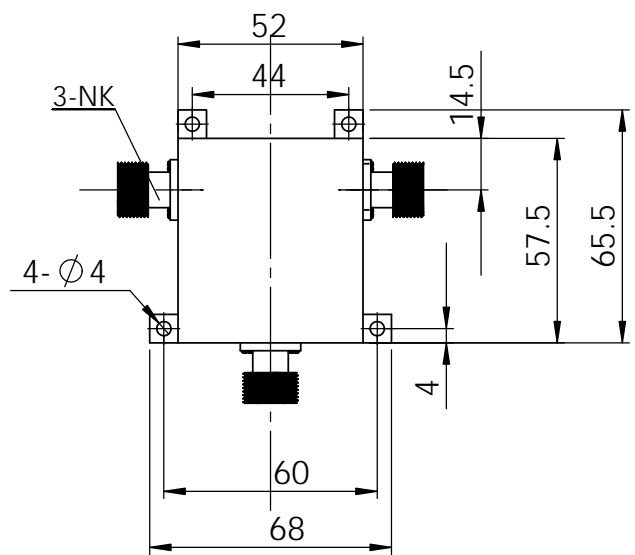

**SPECIFICATIONS**

P/N: JCC0280T0300S10  
 FREQ: 0.280~0.300GHZ

ISOLATION: 20dB MIN  
 INS LOSS: 0.4dB MAX  
 VSWR: 1.20:1 MAX  
 POWER: 100W AVG  
 CIRCULATION: CLOCKWISE  
 CONNECTOR: SMA-FEMALE  
 TEMPERATURE OPERATING: -20C~+60C  
 STORAGE: -55C~+125C

CONNECTOR OPTION: N-F, N-M, SMA-F, SMA-M  
 DRAWING SHOWS N-F BY DEFAULT,  
 ACTUAL CONNECTOR CONFIGURATION  
 REFERES TO SPECS.

This document is the property of JQL Electronic Inc.  
 It cannot be copied, duplicated, used for manufacturing purposes  
 or communicated to third party as a whole or partly,  
 without the written consent of JQL Electronic Inc.

**JQL JQL Electronic Inc** 500 Lake Cook Road, Suite 350 Tel : 1(888)236-9828  
 Deerfield, IL 60015, USA Fax: 1(630)823-2902

MATERIAL: STEEL Y15	DWG NO. JCC0280T0300S10			
SURFACE TREATMENT: NICKLE PLATING	NAME	DATE	SIGNATURE	REV:
DESCRIPTION: COAX CIRCULATOR	DWG BY:			
	CHK'D BY:			
	APPV'D BY:			
	TOLERANCE Liner: ±0.1mm Angular: ±0.5°		Q.A	A4