

1
2
3
4
5
6

Stock Number

REV.	DESCRIPTION	REVISOR	DATE	APPROVE
0		MH	03.26.11	CH

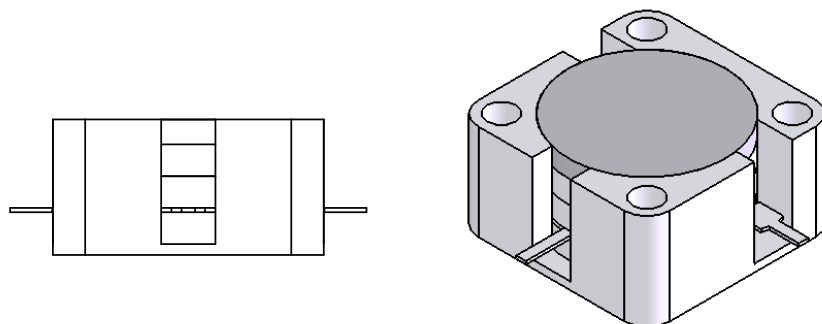

SPECIFICATION

Part's Number: JCD6600T7600VM1
 Frequency: 6.600~7.600GHz
 Direction: CW
 Insertion Loss: 0.4dB MAX.
 Isolation: 20dB MIN.
 VSWR: 1.25:1 MAX
 Power : 10W
 Temperature: -40°C~+85°C

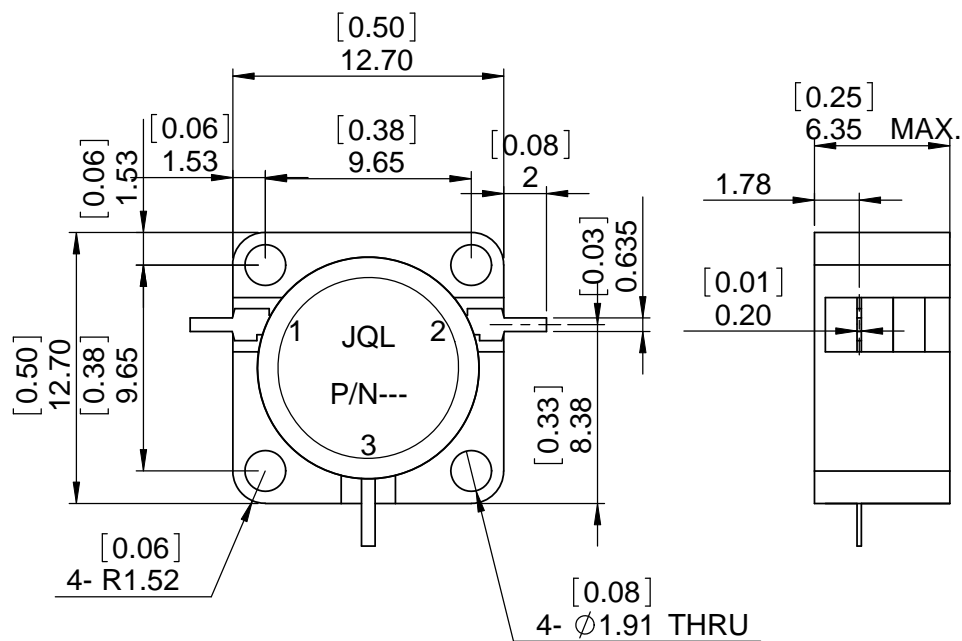

This document is the property of JQL Electronic Inc.
 It cannot be copied, duplicated, used for manufacturing purposes
 or communicated to third party as a whole or partly,
 without the written consent of JQL Electronic Inc.

JQL JQL Electronic Inc

500 Lake Cook Road, Suite 350 Tel : 1(888)236-9828
 Deerfield, IL 60015, USA Fax: 1(630)823-2902

MATERIAL: STEEL	DWG NO. JCD6600T7600VM1		
SURFACE TREATMENT: NICKLE PLATING	SCALE: 1:1		
DESCRIPTION: DROP-IN CIRCULATOR	DWG BY:	NAME MH	DATE 03.26.11
	CHK'D BY:	NAME FW	DATE 03.26.11
	APPV'D BY:	NAME CH	DATE 03.26.11
Unit: mm	TOLERANCE: Liner: ±0.1mm Angular: ±0.5°	Type Of Projection 	A4

WEIGHT:

SHEET 1 OF 1