

1		2		3		4		5		6	
Document No.		QR4-700-T-003		REV.		DESCRIPTION		REVISOR		DATE	
REV.		A/0		0				ZC.Wu		05.29.2015	
								APPROVED		David	

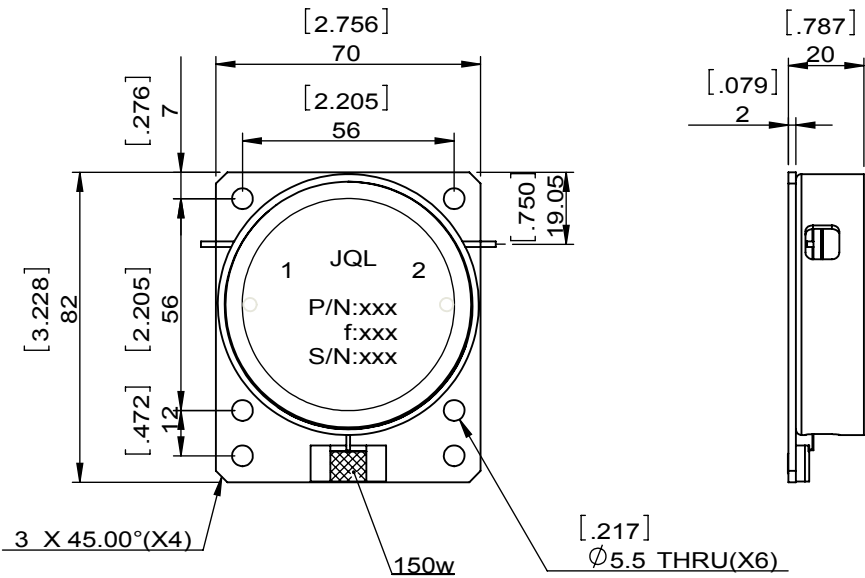

SPECIFICATIONS	
Part's Number	JID0175T0200EM15
Frequency(GHz)	0.175~0.200
Direction	CW
Insertion Loss(dB)MAX	0.3@25±5°C 0.4@-10~+60°C
Isolation(dB)MIN	22.0
Return Loss(dB)MIN	22.0
3rd IMD(dBc)MAX	
Power FWD/REV/PK(Watt)	200/150/-
Operating Temperature(°C)	-10~+60
Storage Temperature(°C)	
2nd/3rd Harmonic(dBc)	-
Termination/Attenuator(Watt/dB)	150W
Tab(W×LG×THK)(mm[Inch])	1.5[0.060]×4.0[0.157]×0.25[0.010]
Additional Notes	Lmpedance:50Ω

JQL JQL Electronic Inc				
MATERIAL: I7082-001		DWG NO: JID0175T0200EM15		
SURFACE TREATMENT: NICKEL PLATING		DWG BY:	ZC.Wu	05.29.2015
DESCRIPTION: DROP IN ISOLATOR		CHK'D BY:		SCALE
		APPV'D BY:		1:2
		Unit: mm[inch]	Tolerance: Liner: ±0.25 Anguar: ±0.5°	The First:
				A4

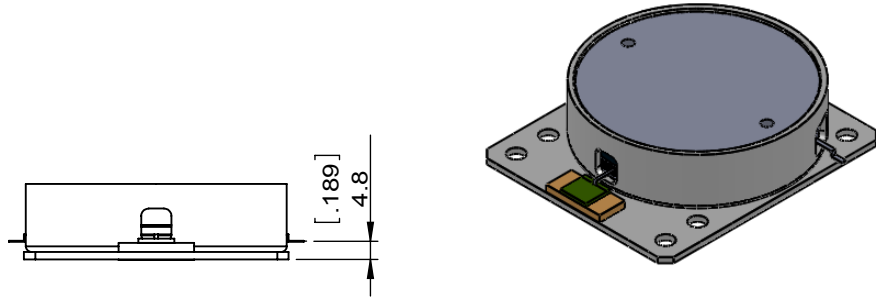

This document is the property of JQL Electronic Inc. It cannot be copied, duplicated, used for manufacturing purposes or communicated to third party as a whole or partly, without the written consent of JQL Electronic Inc.