

1		2		3		4		5		6	
Document No. QR4-700-T-003		REV. A/0		REV.		DESCRIPTION		REVISOR		DATE	
								ZC.Wu		06.29.2015	
										APPROVED	
										David	

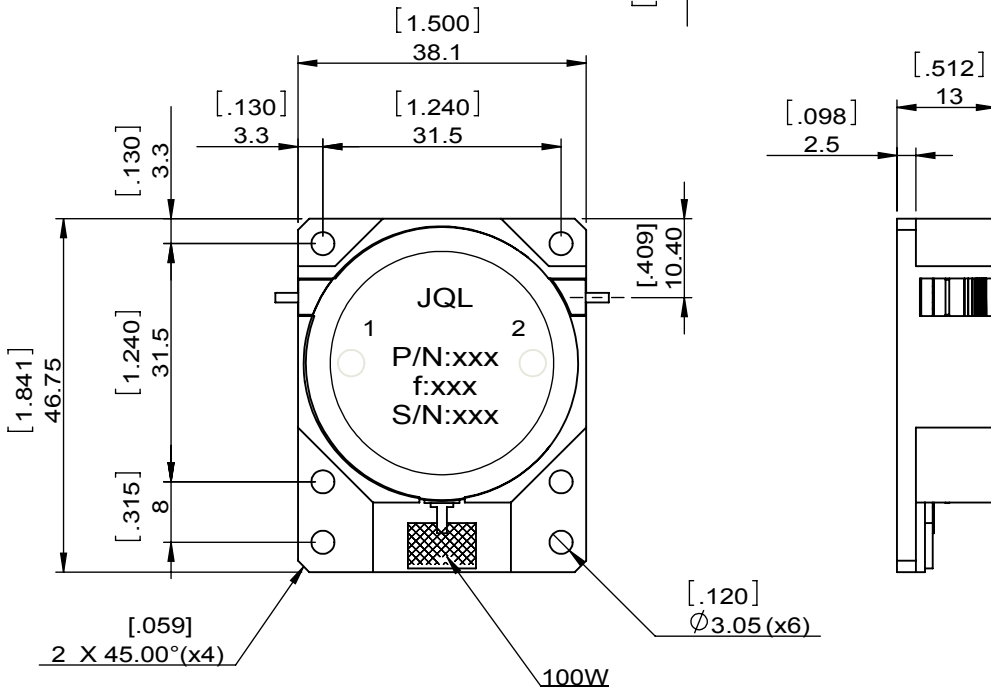

SPECIFICATIONS	
Part's Number	JID0380T0430KM10
Frequency(GHz)	0.380~0.430
Direction	CW
Insertion Loss(dB)MAX	0.30
Isolation(dB)MIN	20.0
Return Loss(dB)MIN	20.0
3rd IMD(dBc)MAX	-
Power FWD/REV/PK(Watt)	120/100/
Operating Temperature(°C)	-20~+80
Storage Temperature(°C)	-
2nd/3rd Harmonic(dBc)	-
Termination/Attenuator(Watt/dB)	100/-
Tab(W×LG×THK)(mm[Inch])	1.30[0.051]x3[0.118]x0.2[0.008]
Additional Notes	-

JQL JQL Electronic Inc	
MATERIAL: STEEL	DWG NO: JID0380T0430KM10
SURFACE TREATMENT: NICKEL PLATING	DWG BY: ZC.Wu 06.29.2015 SCALE 1:1
DESCRIPTION: DROP-IN ISOLATOR	CHK'D BY:
	APPV'D BY:
Unit: mm[inch]	Tolerance: Liner: ±0.25 Anguar: ±0.5°
	The First:
	A4

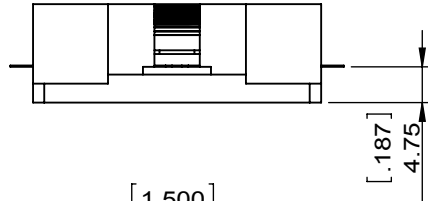
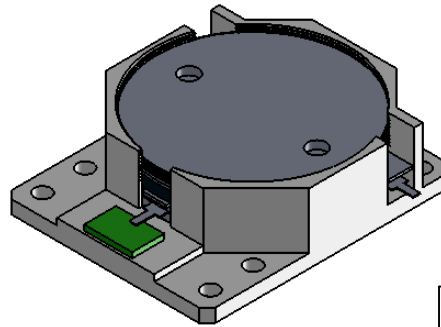

This document is the property of JQL Electronic Inc. It cannot be copied, duplicated, used for manufacturing purposes or communicated to third party as a whole or party, without the written consent of JQL Electronic Inc.