

1		2		3		4		5		6	
Document No.	QR4-700-T-003	REV.	A/0	REV.	DESCRIPTION	REVISOR	DATE	APPROVED			
				0		M.Hao	05.05.2011	David			
				1	Change the IMD	M.Hao	11.26.2013	David			

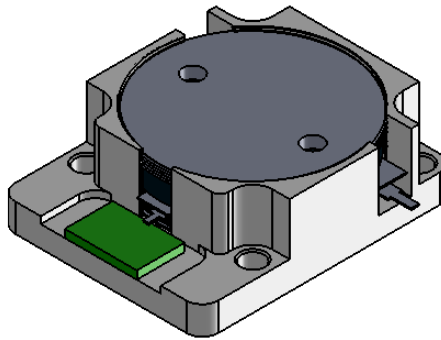

SPECIFICATIONS	
Part's Number	JID0869T0960M10
Frequency(GHz)	0.869~0.960
Direction	CW
Insertion Loss(dB)MAX	0.30
Isolation(dB)MIN	22.0
Return Loss(dB)MIN	22.0
3rd IMD(dBc)MAX	75@2X47dBm
Power FWD/REV/PK(Watt)	150/60/-
Operating Temperature(°C)	-20~+80
Storage Temperature(°C)	-
2nd/3rd Harmonic(dBc)	-
Termination/Attenuator(Watt/dB)	100
Tab(W×LG×THK)(mm[Inch])	1.1[0.043]x2.5[0.098]x0.2[0.008]
Additional Notes	-

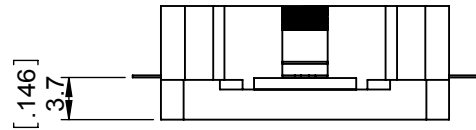
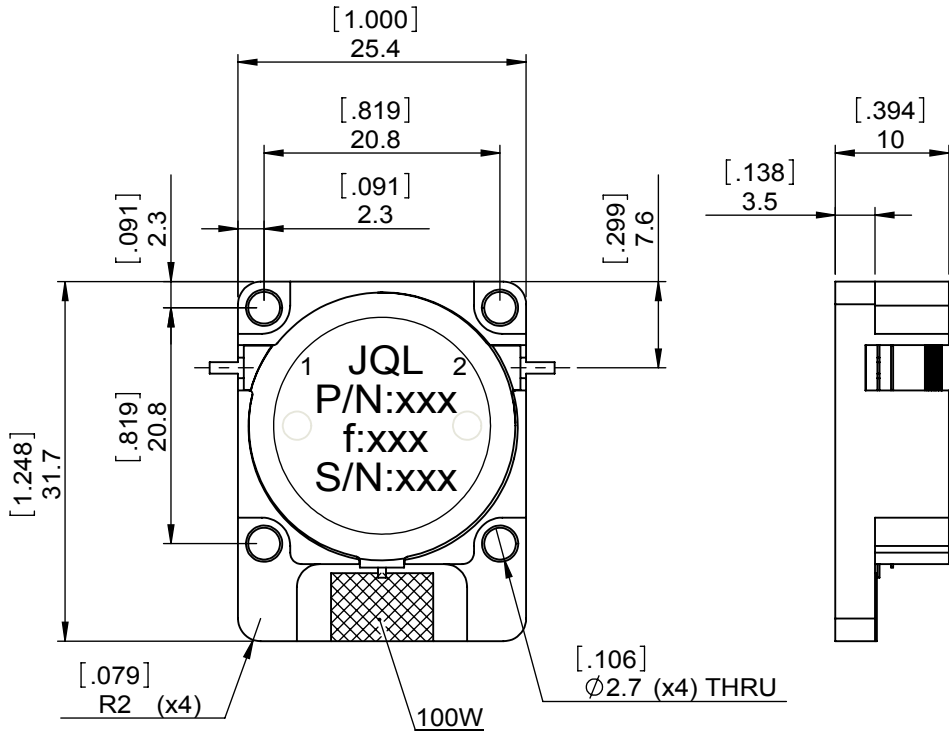

JQL JQL Electronic Inc 500 Lake Cook Road, Suite 350 Deerfield, IL 60015, USA Tel: 1(888)236-9828 Fax: 1(888)823-2902

MATERIAL: STEEL	DWG NO: JID0869T0960M10			
SURFACE TREATMENT: NICKEL PLATING	DWG BY:	M.Hao	05.05.2011	SACLE
	CHK'D BY:			
DESCRIPTION: DROP IN ISOLATOR	APPV'D BY:			3:2
	Unit: mm[inch]	Tolerance: Liner: ±0.25 Anguar: ±0.5°	The First:	A4



This document is the property of JQL Electronic Inc. It cannot be copied, duplicated, used for manufacturing purposes or communicated to third party as a whole or partly, without the written consent of JQL Electronic Inc.