

1		2		3		4		5		6	
Document No.	QR4-700-T-003	REV.	A/0	REV.	DESCRIPTION	REVISOR	DATE	APPROVED			
		0		JP.Yang	07.12.2013	David					

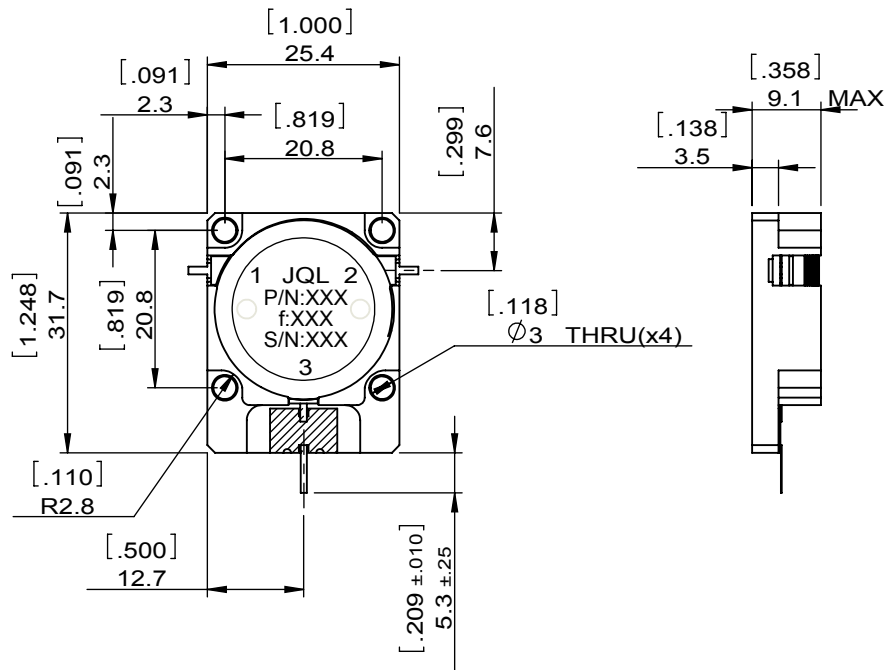
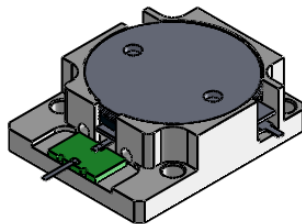
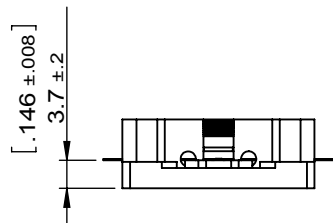

SPECIFICATIONS	
Part's Number	JID1800T1885M10A3
Frequency(GHz)	1.800~1.885
Direction	CCW
Insertion Loss(dB)MAX	0.2Max@25°C 0.25Max(-10°C~+80°C) 0.3Max(-40°C~+100°C)
Isolation(dB)MIN	25.0Min@25°C 23.0Min(-10°C~+80°C) 21.0Min(-40°C~+100°C)
Return Loss(dB)MIN	25.0Min@25°C 23.0Min(-10°C~+80°C) 21.0Min(-40°C~+100°C)
3rd IMD(dBc)MAX	-75(2x40W,5MHz sparation)
Power FWD/REV/PK(Watt)	200(-40°C~+100°C)/ 100(Last more than one minutes at 85°C)/-
Operating Temperature(°C)	-40~+100
Storage Temperature(°C)	-
2nd/3rd Harmonic(dBc)	-
Termination/Attenuator(Watt/dB)	100/30
Tab(W×LG×THK)(mm[Inch])	1.0[.040]x2.5±0.3[.100±.012]x0.2[.008]
Additional Notes	-

JQL **JQL Electronic Inc** 500 Lake Cook Road, Suite 350 Deerfield, IL 60015, USA Tel: 1(888)236-9828 Fax: 1(888)823-2902

MATERIAL: STEEL	DWG NO: JID1800T1885M10A3			
SURFACE TREATMENT: NICKEL PLATING	DWG BY:	JP.Yang	07.12.2013	SACLE
	CHK'D BY:			
DESCRIPTION: DROP-IN ISOLATOR	APPV'D BY:			1:1
	Unit: mm[inch]	Tolerance: Liner: ±0.25 Anguar: ±0.5°	The First:	A4



This document is the property of JQL Electronic Inc. It cannot be copied, duplicated, used for manufacturing purposes or communicated to third party as a whole or partly, without the written consent of JQL Electronic Inc.