

| | | | | | | | | | | | |
|--------------|---------------|------|-----|------|-------------|----------|------------|----------|--|---|--|
| 1 | | 2 | | 3 | | 4 | | 5 | | 6 | |
| Document No. | QR4-700-T-003 | REV. | A/0 | REV. | DESCRIPTION | REVISOR | DATE | APPROVED | | | |
| | | 0 | | | | Hu.Jiang | 09.12.2019 | HC.Qiu | | | |

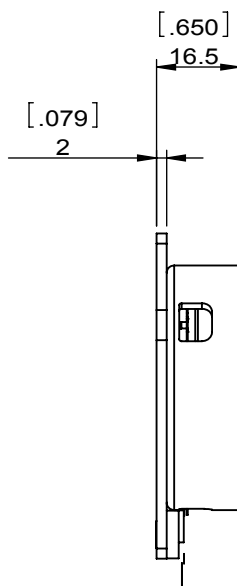

| SPECIFICATIONS | |
|---------------------------------|--------------------------------|
| Part's Number | JID0290T0320UM10 |
| Frequency(GHz) | 0.290~0.320 |
| Direction | CW |
| Insertion Loss(dB)MAX | 0.4 |
| Isolation(dB)MIN | 23.0 |
| Return Loss(dB)MIN | 21.0 |
| 3rd IMD(dBc)MAX | - |
| Power FWD/REV/PK(Watt) | 150/110/- |
| Operating Temperature(°C) | -30~+75 |
| Storage Temperature(°C) | - |
| 2nd/3rd Harmonic(dBc) | - |
| Termination/Attenuator(Watt/dB) | 150 |
| Tab(W×LG×THK)(mm[Inch]) | 1.27[.050]×4[0.157]×0.2[0.008] |
| Additional Notes | - |

| | | | | |
|---|--|------------------------------------|---|----------------|
| JQL JQL Electronic Inc | | | | |
| MATERIAL: STEEL | | DWG NO: JID0290T0320UM10 | | |
| SURFACE TREATMENT: NICKEL PLATING | | DWG BY: | Hu.Jiang | 09.12.2019 |
| DESCRIPTION: DROP-IN ISOLATOR | | CHK'D BY: | | SACLE |
| | | APPV'D BY: | | 2:3 |
| | | Unit: mm[inch] | Tolerance: Liner: ±0.25 Anguar: ±0.5° | The First: |
| | | | | A4 |

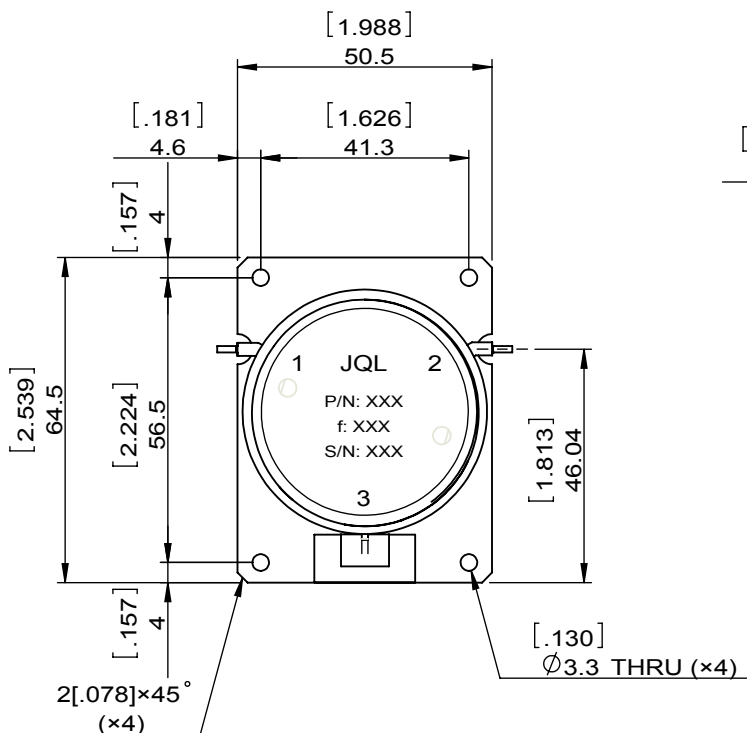
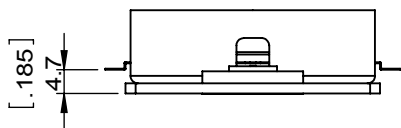
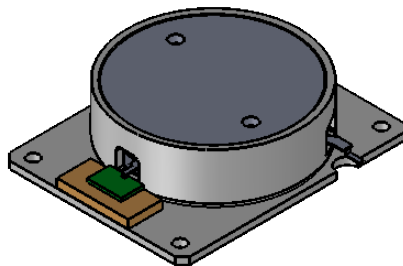

This document is the property of JQL Electronic Inc. It cannot be copied, duplicated, used for manufacturing purposes or communicated to third party as a whole or partly, without the written consent of JQL Electronic Inc.