

1	2
Document No.	QR4-700-T-003
REV.	A/0

3	4	5	6	
REV.	DESCRIPTION	REVISOR	DATE	APPROVED
0		Hu.Jiang	08.26.2019	HC.Qiu

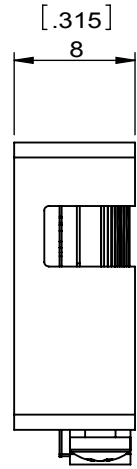
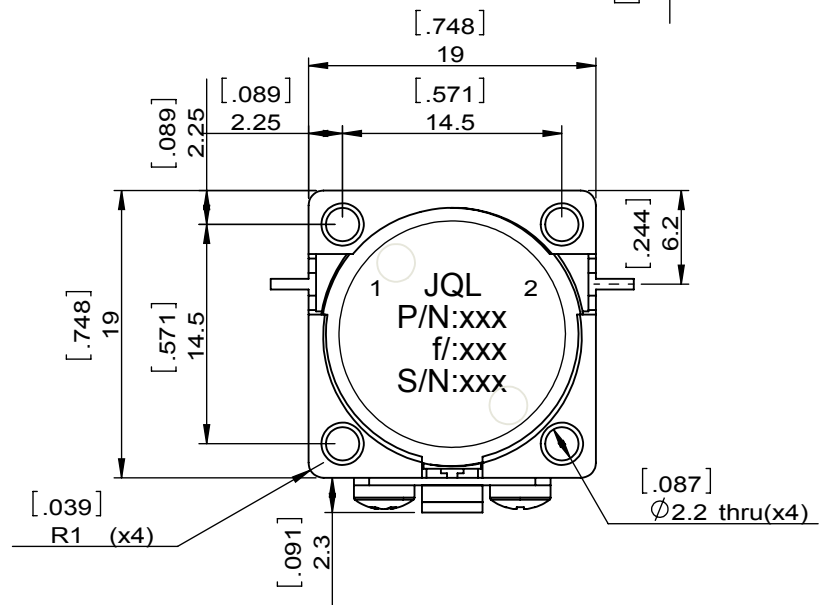
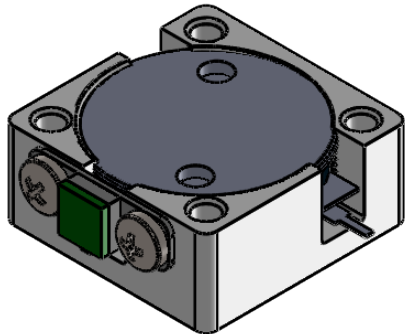
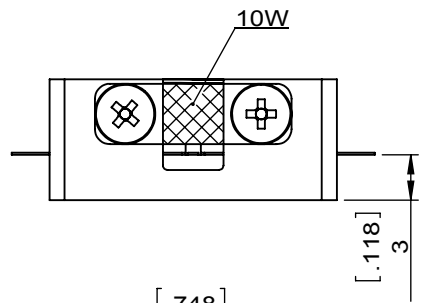

SPECIFICATIONS	
Part's Number	JID2750T3150SM1
Frequency(GHz)	2.750~3.150
Direction	CW
Insertion Loss(dB)MAX	0.4
Isolation(dB)MIN	18.0
Return Loss(dB)MIN	18.0
3rd IMD(dBc)MAX	-
Power FWD/REV/PK(Watt)	10/10/-
Operating Temperature(°C)	-40~+85
Storage Temperature(°C)	--
2nd/3rd Harmonic(dBc)	-
Termination/Attenuator(Watt/dB)	10/--
Tab(W×LG×THK)(mm[Inch])	0.7[.028]×2.5[.098]×0.2[.008]
Additional Notes	-

JQL JQL Electronic Inc				
MATERIAL: STEEL		DWG NO: JID2750T3150SM1		
SURFACE TREATMENT: NICKEL PLATING		DWG BY:	Hu.Jiang	08.26.2019
DESCRIPTION: DROP-IN ISOLATOR		CHK'D BY:		SCALE
		APPV'D BY:		2:1
		Unit: mm[inch]	Tolerance: Liner: ±0.25 Anguar: ±0.5°	The First:
				A4

RoHS COMPLIANCE

This document is the property of JQL Electronic Inc. It cannot be copied, duplicated, used for manufacturing purposes or communicated to third party as a whole or partly, without the written consent of JQL Electronic Inc.