

1		2		3		4		5		6	
Document No.	QR4-700-T-003	REV.	A/0	REV.	DESCRIPTION	REVISOR	DATE	APPROVED			
		0		J.Z		10.09.2022	HC.Qiu				

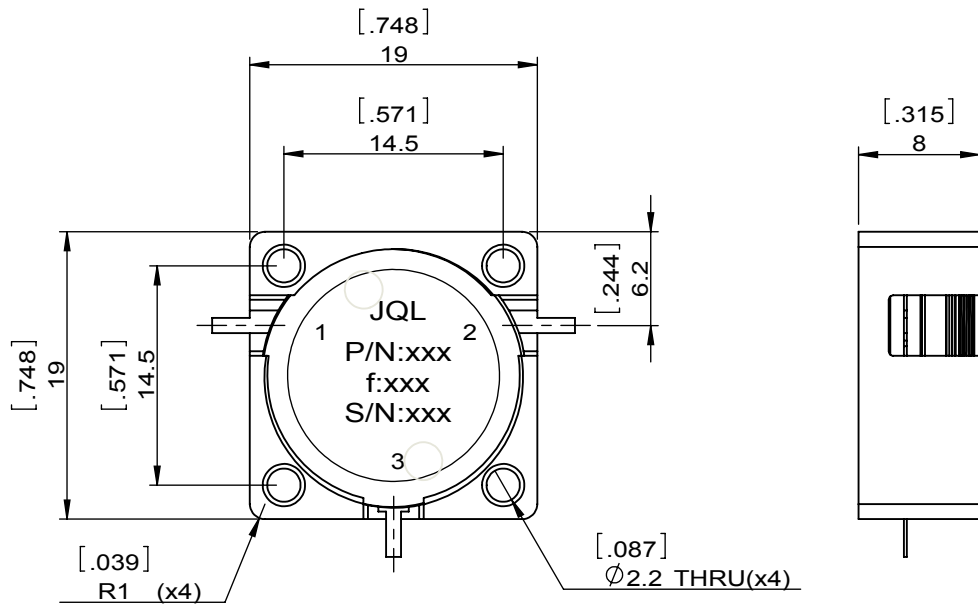

SPECIFICATIONS	
Part's Number	JCD3300T4200M8
Frequency(GHz)	3.300~4.200
Direction	CW
Insertion Loss(dB)MAX	0.40
Isolation(dB)MIN	18.0
Return Loss(dB)MIN	18.0
3rd IMD(dBc)MAX	-
Power FWD/REV/PK(Watt)	80/80/300
Operating Temperature(°C)	-40~+75
Storage Temperature(°C)	-
2nd/3rd Harmonic(dBc)	-
Termination/Attenuator(Watt/dB)	-
Tab(W×LG×THK)(mm[Inch])	1.0[.039]x2.5[.098]x0.2[.008]
Additional Notes	-

- NOTES:**
- 1.STANDARD INPUT/OUTPUT 50OHM IMPEDANCE
  - 2.BEO FREE,LEAD FREE,NO Nd MATERIAL
  - 3.RoHS COMPLIANT
  - 4.S-PARAMETERS TO BE MEASURED BY CONECTING PORT 1 AND PORT 2 TO VNA,PORT 3 TO LOAD
  - 5.LOAD RETURN LOSS IS 30dB OR HIGHER WHEN TUNING

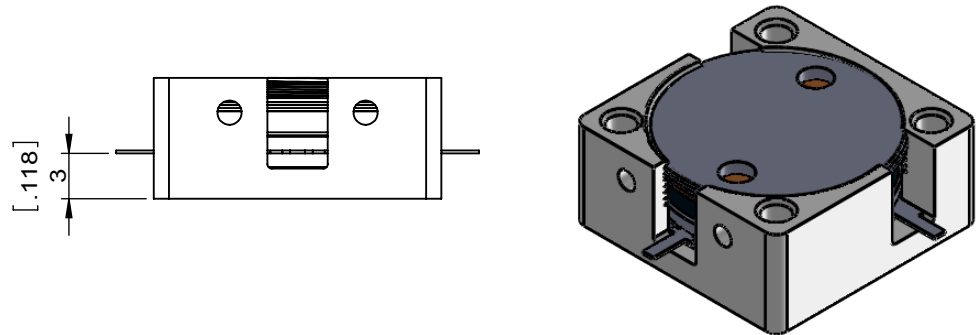

This document is the property of JQL Technologies Corporation. It cannot be copied, duplicated, used for manufacturing purposes or communicated to third party as a whole or partly, without the written consent of JQL Technologies Corporation.

<b>JQL JQL Technologies Corporation</b>				
<b>MATERIAL:</b> STEEL		<b>DWG NO:</b> JCD3300T4200M8		
<b>SURFACE TREATMENT:</b> NICKEL PLATING		DWG BY:	J.Z	10.09.2022
<b>DESCRIPTION:</b> DROP-IN CIRCULATOR		CHK'D BY:		SCALE
		APPV'D BY:		2:1
Unit: mm[inch]		Tolerance: Liner: ±0.25 Anguar: ±0.5°	The First:	A4