

S Band Surface Mount Circulator

JCM3100T3500VM5R

Description:



JCM3100T3500VM5R is a surface mount circulator in the frequency 3.100~3.500 GHz. The device is extremely stable over the temperature range of -40°C to +110°C, with maximum insertion loss of 0.30dB@Typ || 0.35dB @-40~+85°C || 0.40dB@+85~+110°C and minimum return loss of 20.0dB @Typ || 18.0dB @-40~+85°C || 17.0dB @+85~+110°C. This circulator can handle a CW Power FWD/REV/PK(Watt) of 50/50/500 (PW=1mSec & DC=20%)

Electrical Specification

Part Number	JCM3100T3500VM5R
Frequency (MHz)	3.100~3.500
Insertion Loss(dB)MAX	0.30@Typ 0.35@-40~+85°C 0.40@+85~+110°C
Isolation(dB)MIN	20.0@Typ 18.0@-40~+85°C 17.0@+85~+110°C
Return Loss(dB)MIN	20.0@Typ 18.0@-40~+85°C 17.0@+85~+110°C
Operating Temperature	-40°C~+110°C
Power FWD/REV/PK(Watt)	50/50/500 (PW=1mSec & DC=20%)

Outline

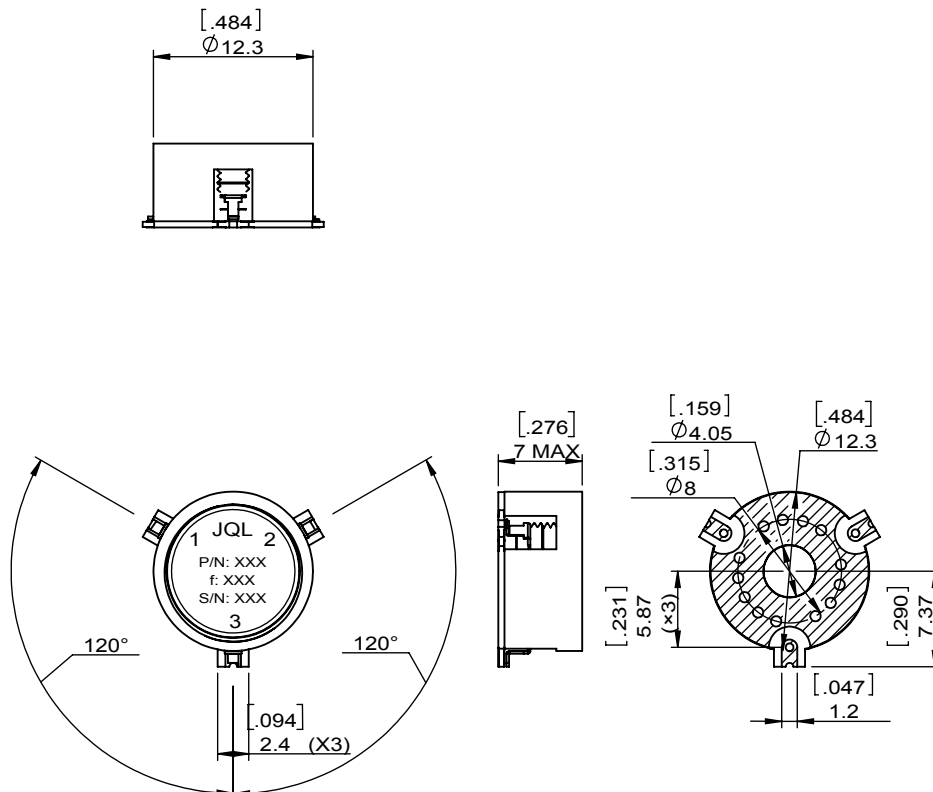

S Band Surface Mount Circulator

JCM3100T3500VM5R

Test Data

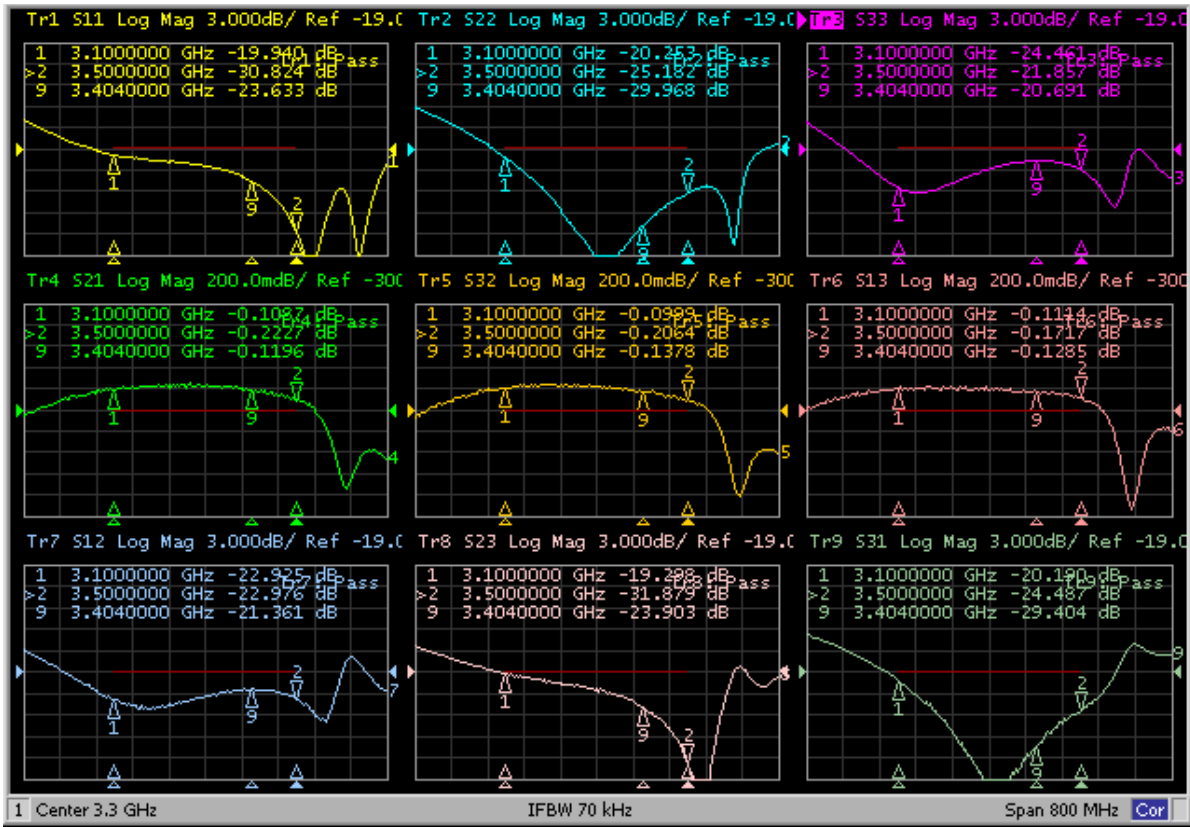

Applications

- Radio Link