

S Band Surface Mount Circulator

JCM3700T4200PK5

Description:



JCM3700T4200PK5 is a surface mount circulator in the frequency 3.700~4.200 GHz. The device is extremely stable over the temperature range of -40°C to +85°C, with maximum insertion loss of 0.30@+25°C || 0.35@-40~+85°C and minimum return loss of 21.0@+25°C || 19.0@-40~+85°C. It can handle a CW Power FWD/REV/PK(Watt) of 50/50/100

Electrical Specification

Part Number	JCM3700T4200PK5
Frequency (GHz)	3.700~4.200
Insertion Loss(dB)MAX	0.30@+25°C 0.35@-40~+85°C
Isolation(dB)MIN	21.0@+25°C 19.0@-40~+85°C
Return Loss(dB)MIN	21.0@+25°C 19.0@-40~+85°C
Operating Temperature	-40°C~85°C
Power FWD/REV/PK(Watt)	50/50/100

Outline

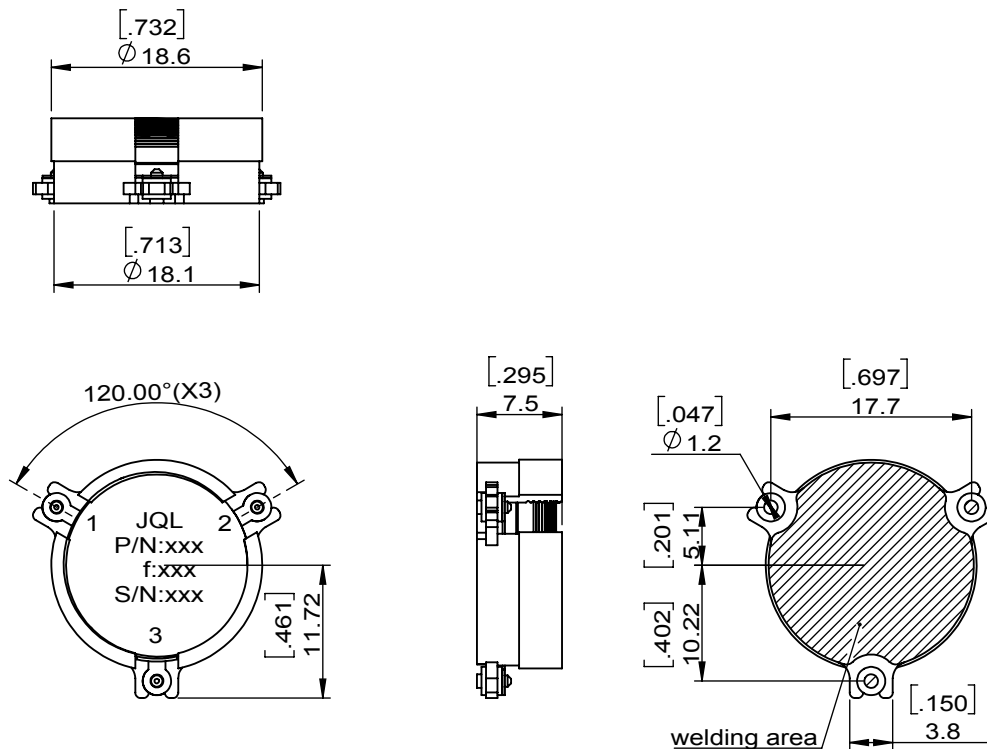

S Band Surface Mount Circulator

JCM3700T4200PK5

Test Data

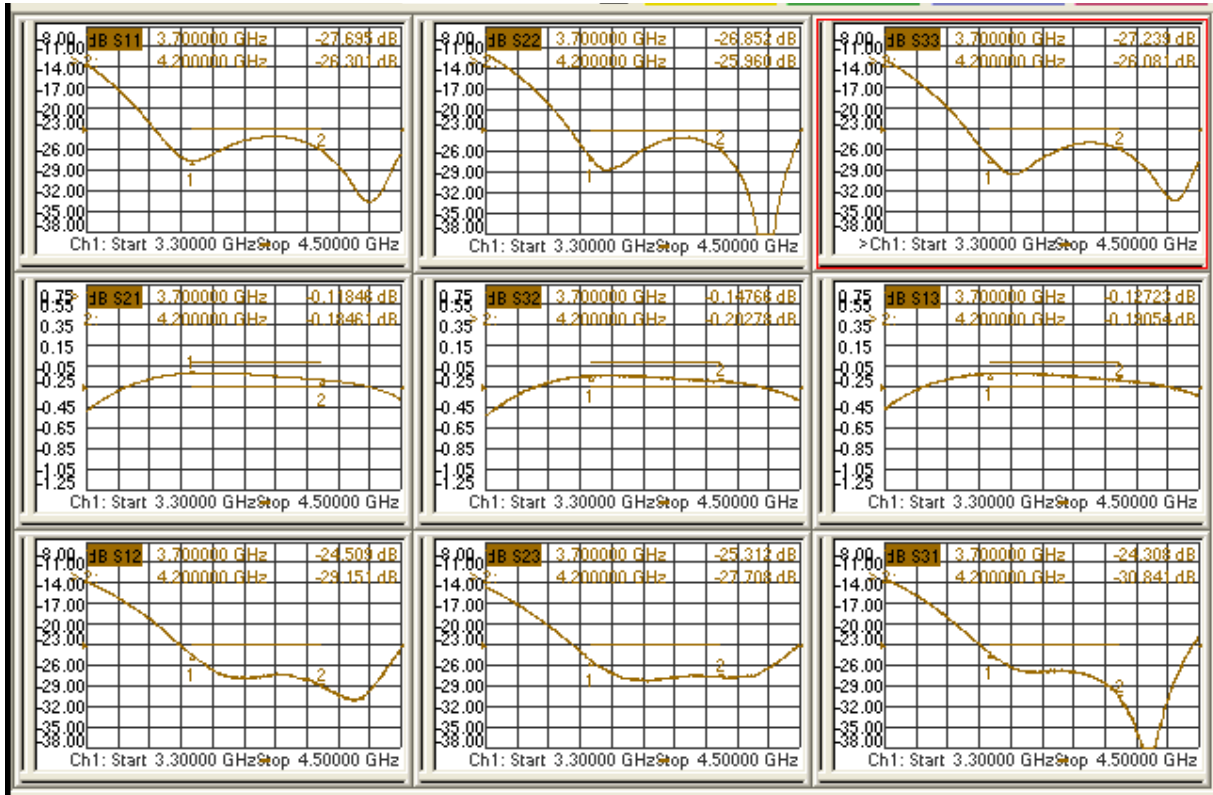

Applications

- Telecom

JQL TECHNOLOGIES
TECHNOLOGY ON THE MOVE