

S Band Surface Mount Circulator

JCM2620T2690PK80

Description:



JCM2620T2690PK80 is a surface mount circulator in the frequency 2.620~2.690GHz. The device is extremely stable over the temperature range of -40°C to +120°C, with maximum insertion loss of 0.35 and minimum return loss of 20.0. It can handle a CW Power FWD/REV/PK(Watt) of 150/150/800

Electrical Specification

Part Number	JCM2620T2690PK80
Frequency (GHz)	2.620~2.690
Insertion Loss(dB)MAX	0.35
Isolation(dB)MIN	20.0
Return Loss(dB)MIN	20.0
Operating Temperature	-40°C~120°C
Power FWD/REV/PK(Watt)	150/150/800

Outline

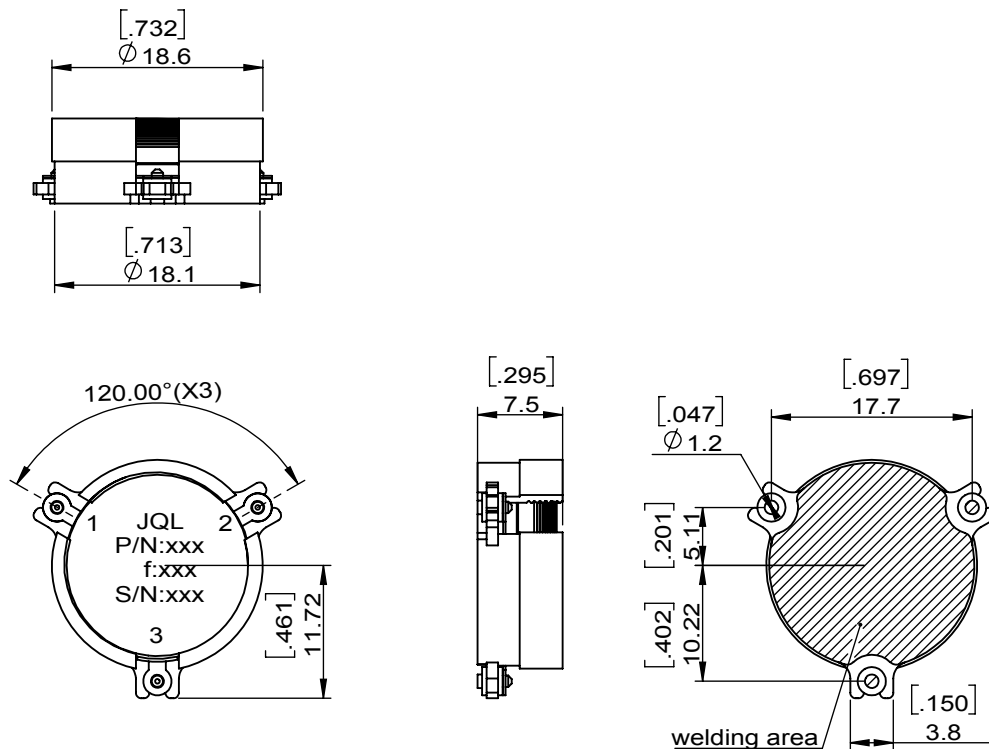

S Band Surface Mount Circulator

JCM2620T2690PK80

Test Data

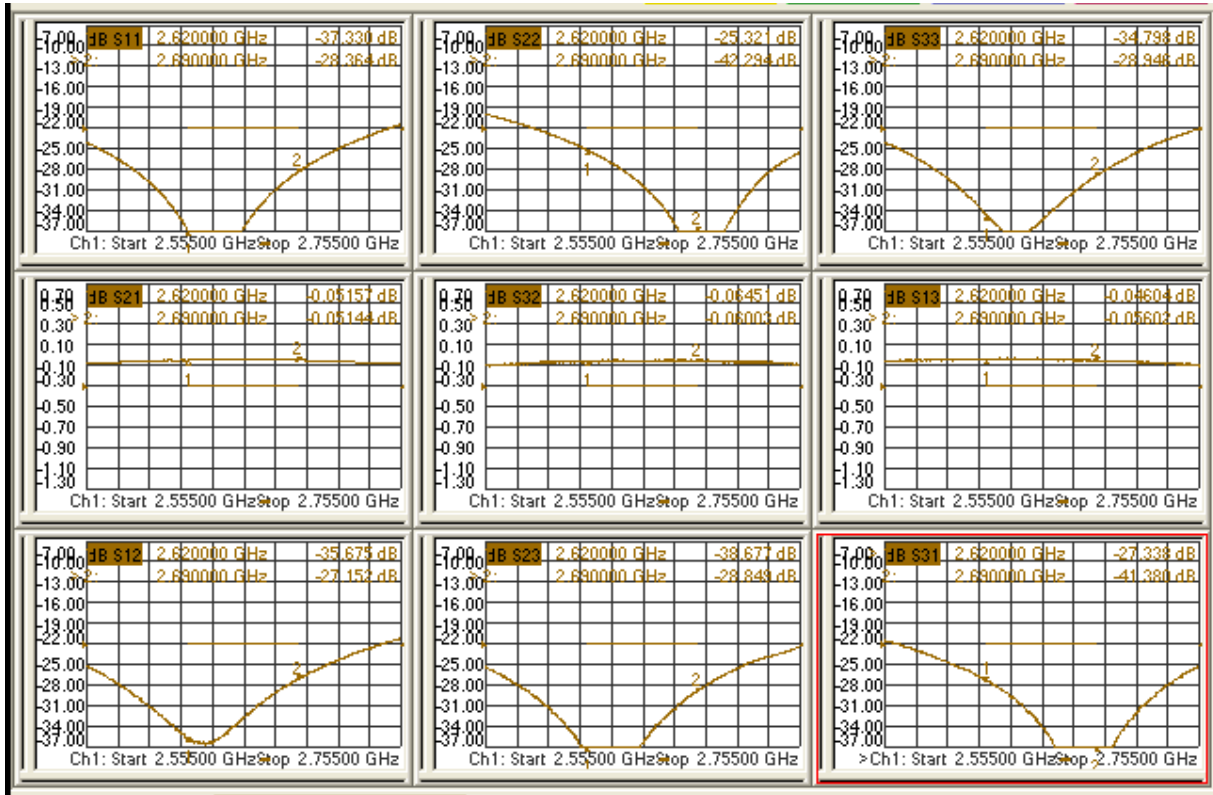

Applications

- Telecom